

"Save
 Your
 Breath
 With

NST[®]
 MODERN SAFETY TECHNIQUES

11388 Breininger Rd. Phone: (800) 542-6646
 P.O. Box 87 (888) mod-safe
 Hicksville, OH 43526 (419) 542-6645
 Website: www.modsafe.com Fax: (419) 542-6475
 Email: modsafe@bright.net

SERVICE INSTRUCTIONS

RESPIRATORY PROTECTOR MODELS

RP012AA, RP012AMST, RP050AA, RP050AMST AND RP050AA-S1

NOTE: USE REPLACEMENT CARTRIDGE KIT NO. RCRP050/12 FOR ABOVE MODELS

WARNING: Always turn off air supply and bleed air pressure before disassembling unit or serious injury could result.

MST, Inc. recommends replacing all four (4) filter cartridges after on month's use, unless conditions warrant more frequent replacement. To refill or replace the filter cartridges in the Respiratory Protector Model's RP012A(xxx) or RP050A(xxx), follow these steps:

1) Prefilter - First & Second Stages

- A. Loosen five (5) 10518 Manifold Bolts (see Figure No. 1) enough to allow first and second stage cartridges to move freely.
- B. Remove two (2) corner (10518) Bolts with (10521) Washers.
- C. Slide out old filter cartridges.
- D. Remove the plastic filter wrap from the first stage aluminum tube by applying pressure to one end of the filter wrap to press it out.
- E. Clean the tube in soap and water. Wipe dry.
- F. Insert new plastic filter wrap by pressing and turning clockwise into the aluminum tube. Discard holding fiber tube.
- G. Use new (80141) Cap Gaskets and slide the first stage filter cartridge into the Prefilter on the inlet side.
- H. Remove cotton column packing and the stainless steel screen cup from the second stage filter cartridge by applying pressure to one end of the column packing to press it out.
- I. Clean the tube in soap and water. Wipe dry.
- J. Insert new column packing, with the screen cup on the outlet end (top), by pressing the material out of the fiber tube into the aluminum tube. Discard holding filter tube.

WARNING: If column packing is folded or wrinkled when inserted in the tube, water may pass through unit.

- K. Use new (80141) Cap Gaskets and slide the second stage cartridge, with the screen cup on the outlet end (top), into the Prefilter on the outlet side.
- L. Replace corner bolts and washers and finger tighten all five (5) 10518 Manifold Bolts.
- M. Tighten (10518) Manifold Bolts in sequence from center outward to 25 inch-pounds. Repeat sequence and torque bolts to 50 inch-pounds. Recheck for proper torque limit.

TORQUE SEQUENCE
(PREFILTER)

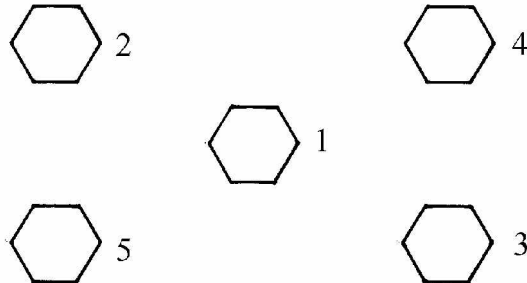

2) Air Scrubber - Third & Fourth Stages

- A. Loosen (S006-148) Bolt from (80001) Base before servicing.
- B. Loosen five (5) S011-040 Manifold Bolts enough to allow the third and fourth stage cartridges assemblies to move freely.
- C. Remove two (2) corner (S011-040) Bolts with (12021) Washers.
- D. Slide out old third and fourth stage cartridge assemblies (see Figure No. 1).
- E. Remove old third stage filter cartridge and cap gasket from the third stage aluminum tube.
- F. Clean the aluminum tube in soap and water. Wipe dry.
- G. Refill the third stage assembly by sliding the new third stage cartridge into the tube from the bottom (see Figure No. 2).
- H. Remove (00411) Label and install new (80006) Cap Gasket on the top of the third stage cartridge.
- I. Slide the new third stage filter cartridge assembly into the Air Scrubber on the inlet side.
- J. Remove the old fourth stage filter cartridge and cap gasket from the fourth stage aluminum tube.
- K. Clean the aluminum tube in soap and water. Wipe dry.
- L. Refill the fourth stage assembly by sliding the new fourth stage cartridge into the tube from the top (see Figure No. 3).
- M. Remove (00411) Label and install new (80006) Cap Gasket on the bottom of the fourth stage cartridge.
- N. Slide the new fourth stage cartridge assembly into the Air Scrubber on the outlet side.
- O. Replace corner bolts and washers and finger tighten all five (5) S011-040 Manifold Bolts.
- P. Tighten (S011-040) Manifold Bolts in sequence from center outward to 100 inch-pounds. Repeat sequence and torque bolts to 250 inch-pounds. Recheck for proper torque limit.

TORQUE SEQUENCE
(THIRD AND FOURTH STAGES)

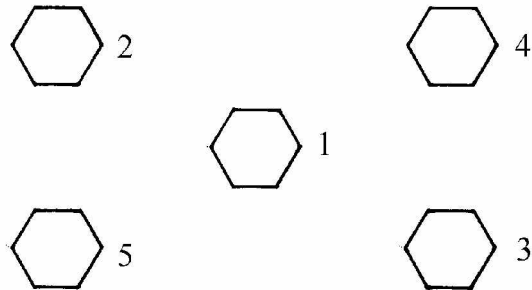

NOTE: Dispose of used filter cartridges in landfill according to local, state and federal regulations.

- 3) Final Check and Calibration.
 - A. Pressurize system and check for leaks.
 - B. Flush system with compressed air for five (5) minutes.
 - C. Calibrate Carbon Monoxide Monitor as outlined in the Monitor's instruction manual.

4) Record Keeping

Record all periodical air quality checks, monitor calibration dates, filter cartridge change intervals and any other service performed on the Respiratory Protector.

MST, Inc. shall not be liable for any injury, loss, or damage, direct or consequential, arising out of the use of or the inability to use this product, beyond the replacement of defective materials or workmanship. Users of supplied air respirators should evaluate their own particular application and perform their own tests for air quality to determine the suitability for use of this product.

For further information or questions about service or maintenance care of the unit contact your local distributor or MST, Inc. at (800) 542-6646.

FILTER ASSEMBLY

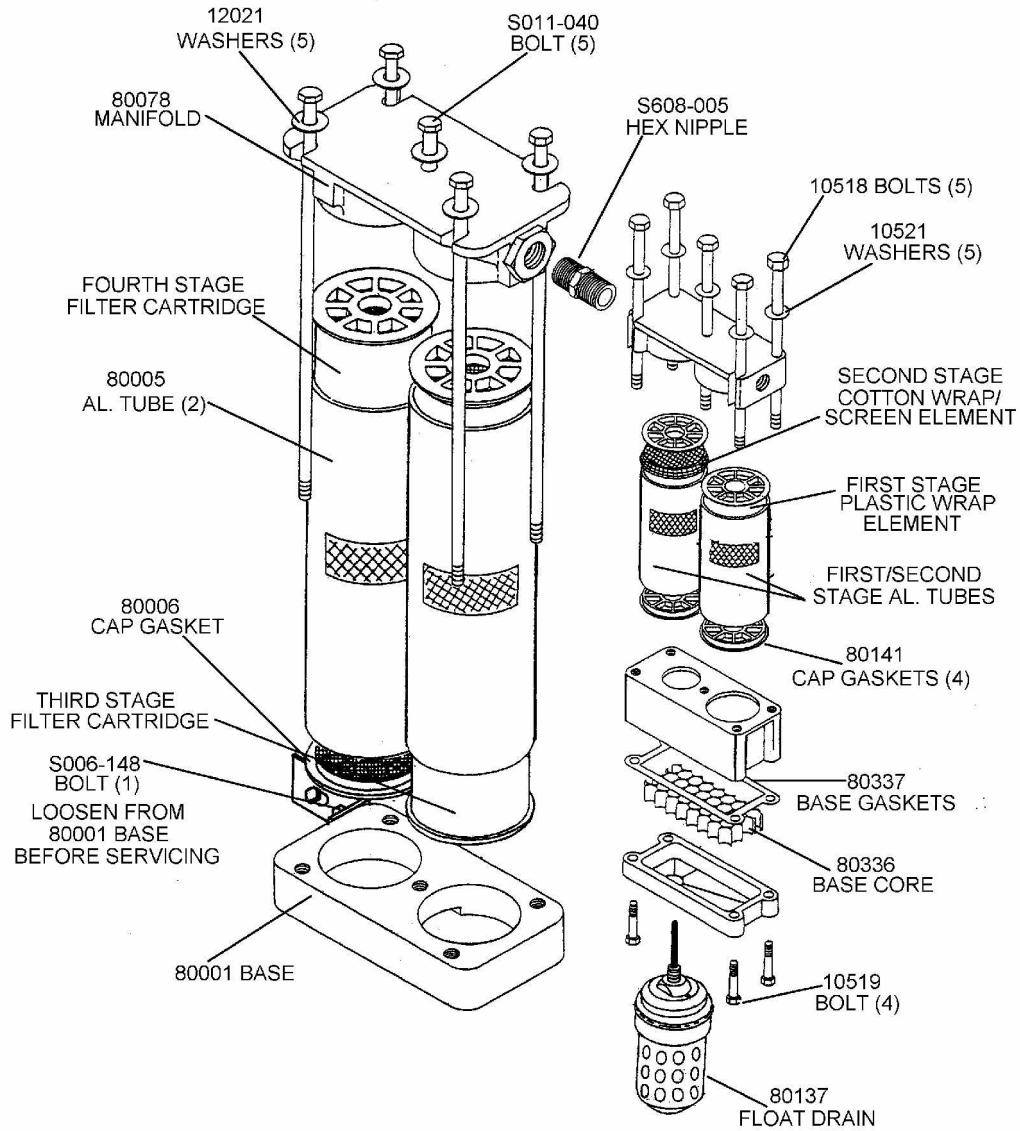

FIGURE NO. 1

THIRD STAGE FILTER ASSEMBLY

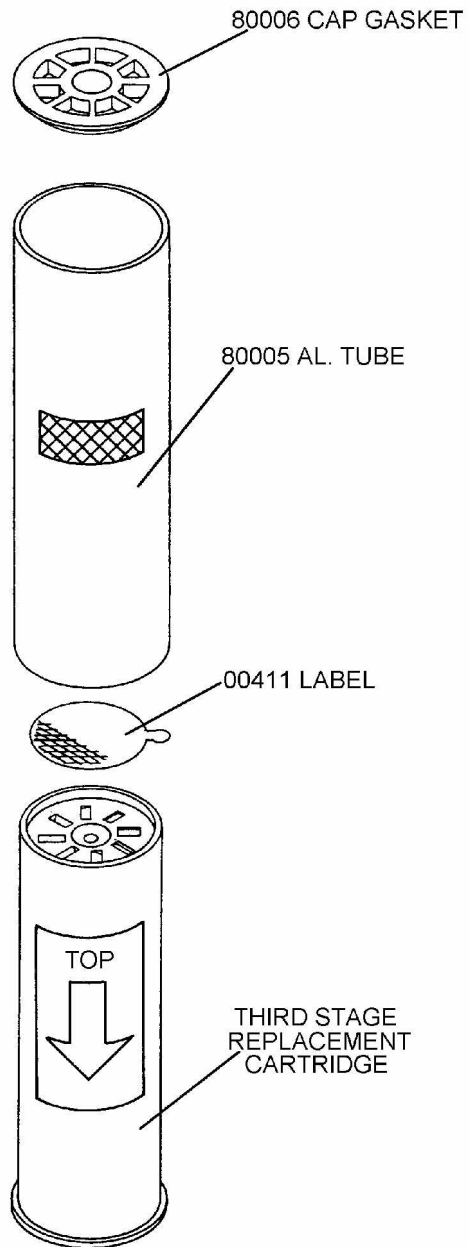

FIGURE NO. 2

FOURTH STAGE FILTER ASSEMBLY

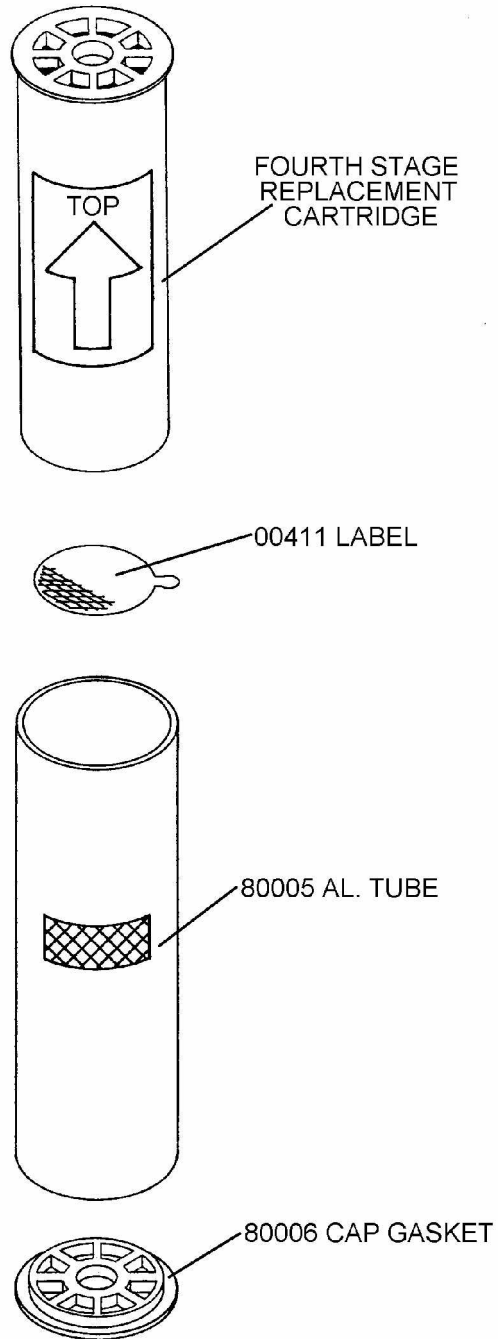

FIGURE NO. 3